

REVISIONS			
REV	DESCRIPTION	DATE	APPROVED

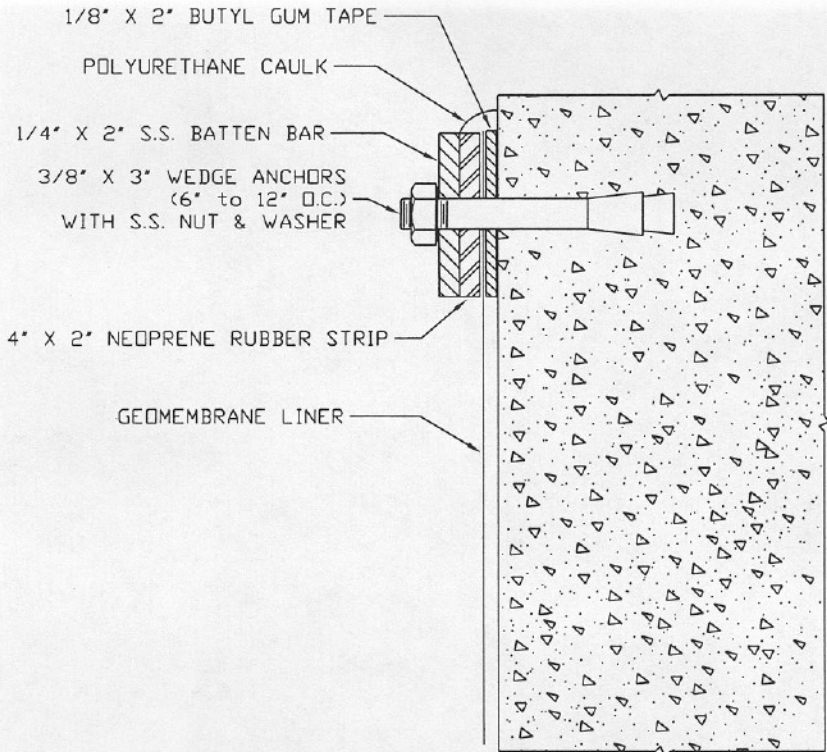

VERTICAL MECHANICAL ATTACHMENT DETAIL
(Below Water)

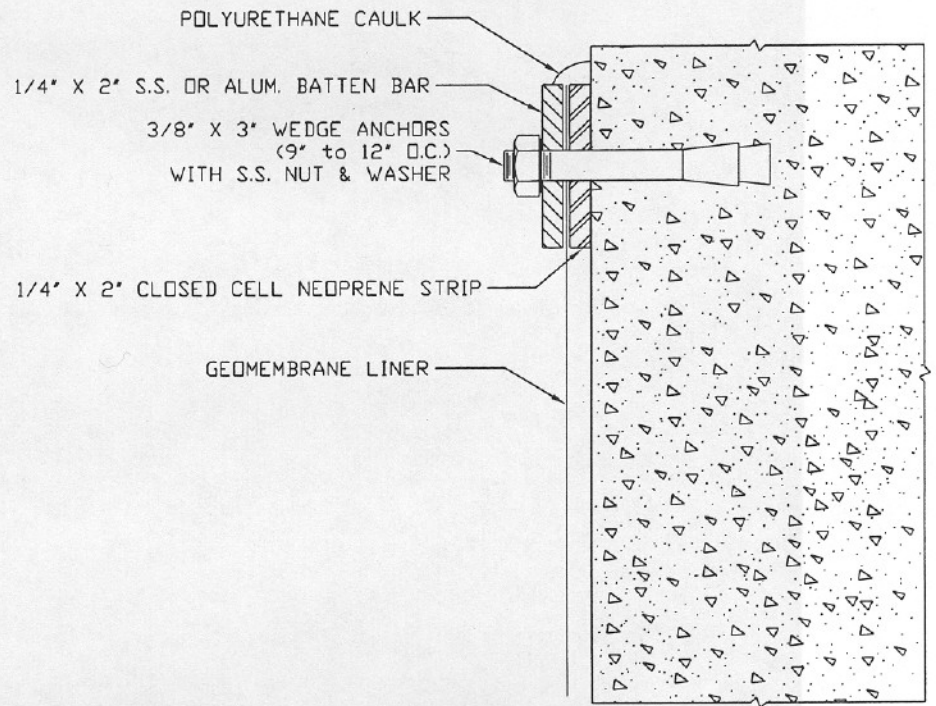

VERTICAL MECHANICAL ATTACHMENT DETAIL
(Secondary Containment / Above Waterline)

NOTE: SAME DETAIL APPLIES FOR HORIZONTAL ATTACHMENT WITH
A SLIGHT CHAMFER ON CONCRETE EDGE.

These drawings are offered as a design aid. Lange Containment Systems, Inc. assumes no liability for actual practices or end use.



™ LANGE CONTAINMENT SYSTEMS, INC.
5150 RACE COURT
DENVER, CO 80216
(303) 446-8644 FAX (303) 446-8798

Customer Name			
Typical Mechanical Attachment Detail			
SIZE: A	DRAWN BY: C. Thomas	APPROVED BY: _____	REV: _____
SCALE: 1" = NTS	DWG NO: Attach_2	SHEET: 1 OF 1	DATE: 2/2/04